

Help Card

Setup Instructions:

1. Plug the AC adapter power cable into the Roku box and wall socket. Roku does not have an on/off switch on the Roku box; it stays on.
2. Plug the HDMI cable into the Roku box and the TV.
3. Select the appropriate video source or input for the television, if necessary.
4. Use the Roku remote to connect to your home Wi-Fi for internet connection.
 - Go to the Settings menu, and select Network.
 - Follow prompts to connect to your home Wi-Fi, and enter a password if your home Wi-Fi requires it.
5. Use the Roku remote to select a channel and watch.



STEP 1: Connect to TV

Connect your streaming player to an HDMI port on the back of your TV using a High Speed HDMI® Cable

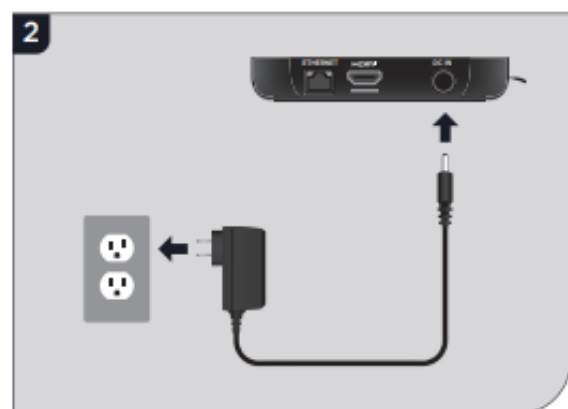

STEP 2: Connect to power

Use the included power adapter to connect your streaming player to a wall outlet.

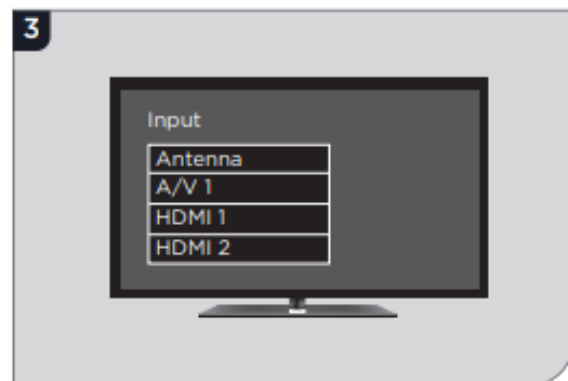

STEP 3: Power on TV and select input

Use your TV remote to power on your TV and select the input you used to connect your streaming player.

For help on how to select the correct input, visit go.roku.com/selectinput

Help Card

Vudu Movies:

1. To access the library's collection of digital movies, use the remote to select the "Vudu" channel.
2. Select "My Vudu", then "Movies" to view our entire digital collection.
3. Click on the title you wish to view using the remote and select "Watch".

