

HORIZONTAL MOTORS

FRAME: 440T
TYPE: CE

PRINT #: 07-2125
EFFECTIVE: 29-JAN-01
SUPERSEDES: 13-APR-99

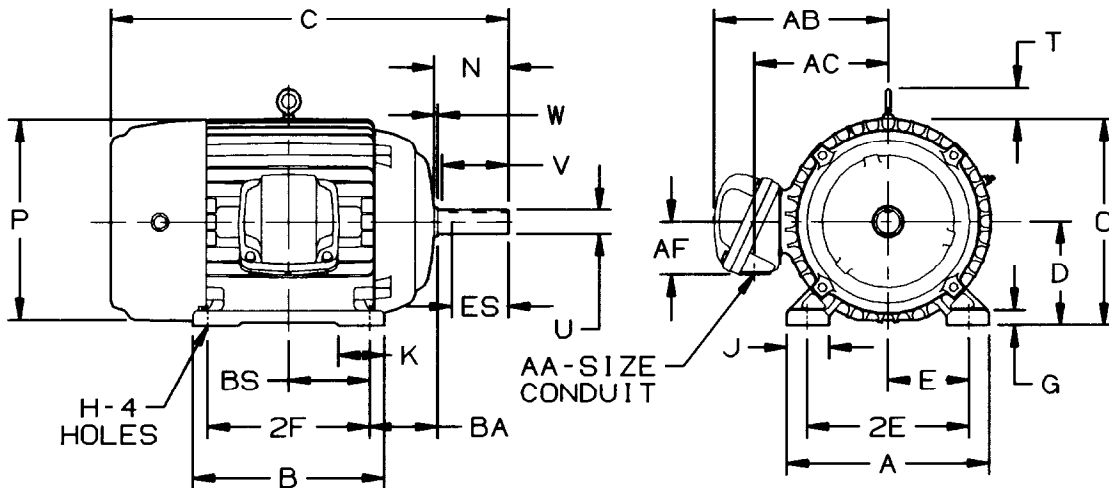

ALL DIMENSIONS ARE IN INCHES & MILLIMETERS

| UNITS | A | E | G | J | K | T | N | O | P ² |
|-------|-------|------|------|------|------|------|------|-------|----------------|
| INCH | 22.00 | 9.00 | 1.50 | 4.00 | 4.00 | 3.25 | 8.63 | 22.75 | 23.50 |
| MM | 559 | 229 | 38 | 102 | 102 | 83 | 219 | 578 | 597 |

| UNITS | V MIN | W | AA | AB | AC | AF | BA | ES MIN | SQ KEY |
|-------|----------|-----|-----------|-------|-------|------|------|-----------|-----------|
| INCH | 8.25 | .13 | 3-1/2 NPT | 21.13 | 16.50 | 8.06 | 7.50 | 6.88 | .875 |
| MM | 210 | 3 | | 537 | 419 | 205 | 191 | 175 | 22.23 |

| UNITS | D ⁴ | 2E ⁴ | H ⁴ | U ⁴ |
|-------|----------------|-----------------|----------------|----------------|
| INCH | -.06 | ±.03 | +.05 | -.001 |
| MM | 11.00 | 18.00 | .81 | 3.375 |
| | 279.4 | 457.2 | 21 | 85.73 |

| FRAME | UNITS | 2F ⁴ ±.03 | B | C | BS |
|-------|-------|-------------------------|-------|-------|-------|
| 444T | INCH | 14.50 | 17.50 | 43.88 | 7.25 |
| | MM | 368.3 | 445 | 1114 | 184 |
| 445T | INCH | 16.50 | 19.50 | 45.88 | 8.25 |
| | MM | 419.1 | 495 | 1165 | 210 |
| 447T | INCH | 20.00 | 23.00 | 49.38 | 10.00 |
| | MM | 508 | 584 | 1254 | 254 |

1: ALL ROUGH CASTING DIMENSIONS MAY VARY BY .25"
DUE TO CASTING VARIATIONS.
2: LARGEST MOTOR WIDTH.

3: CONDUIT BOX MAY BE LOCATED ON EITHER SIDE
OF MOTOR. CONDUIT OPENINGS MAY BE LOCATED IN
STEPS OF 90 DEGREES REGARDLESS OF LOCATION.
STANDARD AS SHOWN WITH CONDUIT OPENING DOWN.
4: TOLERANCE UNITS ARE IN INCHES ONLY.

CERTIFIED BY: _____ DATE: _____

