

EFFECTIVE:
23-MAR-11

HORIZONTAL MOTORS

W/ NEMA "C" BRACKET AND CAST IRON CONDUIT BOX

PRINT:
07-2548

SUPERSEDES:
23-MAR-07

FRAME: 213, 215TC
BASIC TYPE: CE

SHEET:
1 OF 1

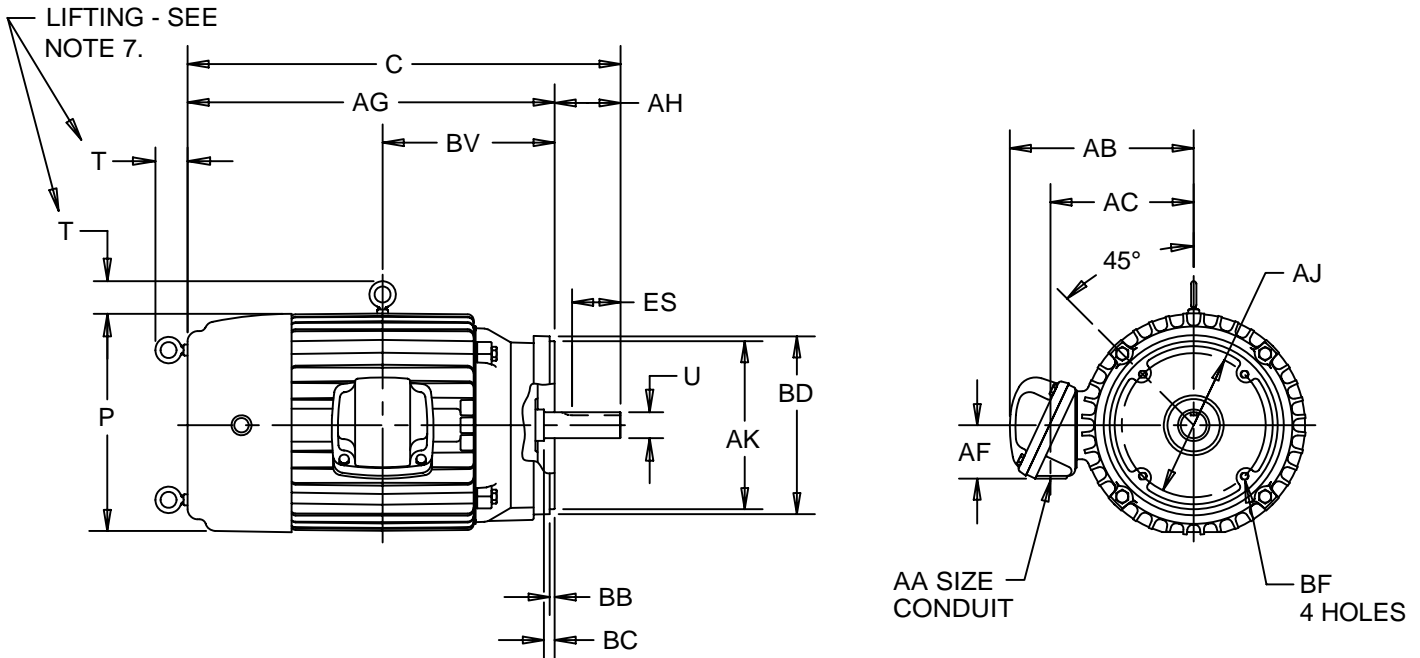

ALL DIMENSIONS ARE IN INCHES AND MILLIMETERS

UNITS	C	P ⁶	T ⁷	U -.0005	AA	AB	AC	AF	AG	AH
IN	20.75	11.13	2.06	1.3750	1 NPT	9.81	7.25	2.00	17.63	3.13
MM	527	283	52	34.925		249	184	51	448	80

UNITS	AJ	AK -.003	BB MIN	BC	BD MAX	BF ²	BV	ES MIN	SQ KEY
IN	7.250	8.500	.25	.25	9.00	1/2-13 X .75	8.00	2.41	.313
MM	184.15	215.90	6	6	229		203	61	7.95

TOLERANCES	
FACE RUNOUT	.004 T.I.R.
PERMISSIBLE ECCENTRICITY OF MOUNTING RABBET	.004 T.I.R.
PERMISSIBLE SHAFT RUNOUT	.002 T.I.R.
FOR SPECIAL SHAFT RUNOUT	.001 T.I.R.

- 1: ALL ROUGH DIMENSIONS MAY VARY BY .25" DUE TO CASTING AND/OR FABRICATION VARIATIONS.
- 2: TAP SIZE AND BOLT PENETRATION ALLOWANCE.
- 3: ALL TAPPED HOLES ARE UNIFIED NATIONAL COARSE, RIGHT HAND THREAD.
- 4: TOLERANCE SHOWN ARE IN INCHES ONLY.

- 5: CONDUIT BOX MAY BE LOCATED ON EITHER SIDE OF MOTOR. CONDUIT OPENINGS MAY BE LOCATED IN STEPS OF 90 DEGREES REGARDLESS OF LOCATION. STANDARD AS SHOWN WITH CONDUIT OPENING DOWN.
- 6: LARGEST MOTOR WIDTH.
- 7: THIS UNIT MAY HAVE HORIZONTAL LIFTING, VERTICAL LIFTING OR BOTH. LIFTING REQUIREMENTS MUST BE SPECIFIED ON THE ORDER.

07-2548/C

Nidec Motor Corporation
St. Louis, Missouri

INFORMATION DISCLOSED ON THIS DOCUMENT IS CONSIDERED PROPRIETARY AND SHALL NOT BE REPRODUCED OR DISCLOSED WITHOUT WRITTEN CONSENT OF NIDEC MOTOR CORPORATION



ISSUED BY
R. KING
APPROVED BY
K. POTTER

IHP_DP_NMCA (MAR-2011) SOLIDEDGE